

Published by

# CUMMINS MAP COMPANY

406 Chambers of Commerce  
Winnipeg, Manitoba

M. S. ARNIEL, Manager

We have these maps for any part of Manitoba, Saskatchewan and Alberta. Also mailing lists of all kinds. Write us for map making, mounting, draughting, etc.

Price \$1.00 Paper Copy

Price \$1.50 Cloth backed Copy. (Any number of Maps can be mounted in one piece making one large map.)

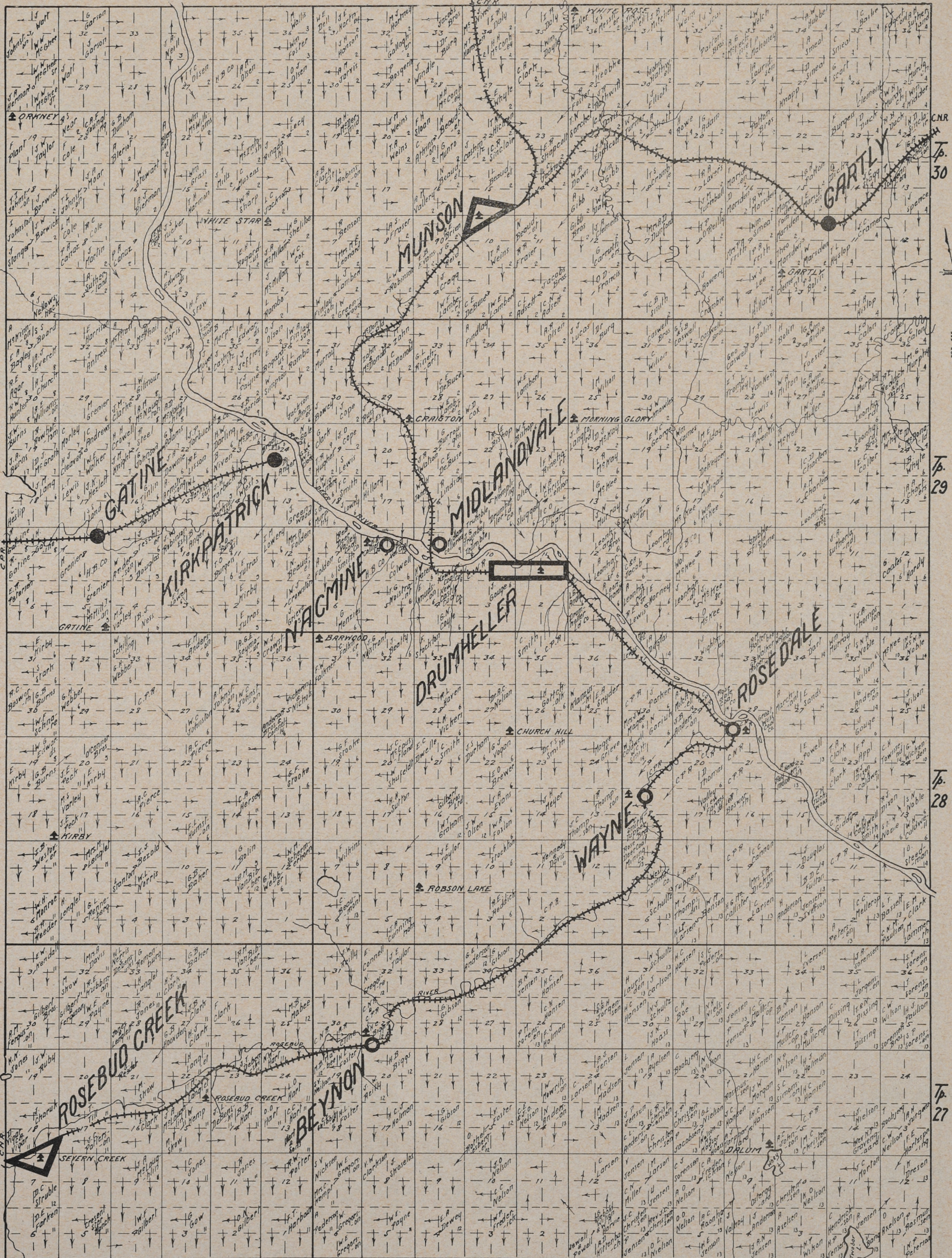

1. GHOST PINE CREEK 3. MORRIN 7. HESKETH 9. MIDLAND VALLEY 11. ROSEBUD CREEK 13. WAYNE  
 2. MUNSON 4. MICHICHI 5. NAGMINE 6. DRUMHELLER 8. CARBON 10. VERDANT VALLEY 12. BEYNON 14. ROSEDALE  
 R.21 R.20 W. of 4 M. R.19 CUMMINS MAP CO. WINNIPEG, MAN. No 81

**LEGEND:** — ↑ Schools    □ Cities    □ Towns    △ Villages    ○ Post Offices    ● Sidings  
 Number below owners name refers to Post Office address, which follows same number at bottom of Map